

INPUT: 220-240~50/60Hz CLASS I

LAMP-HOUSE: GU10-35W (MAX.)

MATERIAL: ALUMINIUM



CE

IP54

INSTALLATION INSTRUCTION

1. Before installing, make sure the power supply is switched off.
2. Follow the steps as the figure for installation or replacement of bulb

Step:

- A. after holing, pull out the wires.
- B. fix the bracket to the wall with screws.
- C. connect the wires to the terminal block.
- D. fix the lamp body to the base with screws.
- E. insert the bulb with gasket to the lamp body.
- F. secure the bulb with lamp shade by twist in clockwise.

3. After finishing every step, tighten the screws, have the fixture fixed, and then connect the power supply.

CLEANING INSTRUCTION

1. Before cleaning, ensure that the power supply is switched off.
2. Use only a soft cloth to clean the lamp, dampened with mild cleanser if needed for resistant dirt.
3. Warning: do not use alcohol or other solvents.

CAUTION:

While the lamp is working, the surface of it is hot!

Please do not touch the fixture within an hour after the power supply has been switched off.

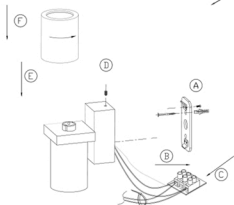
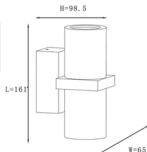
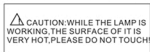

Product coding: CLT 021W